

9 Higson Avenue, Chorlton Green, Manchester, M21 9EP



Offers In The Region Of £375,000



VIDEO TOUR AVAILABLE A delightful, TWO DOUBLE BEDROOM, mid terrace property. This period, bay-fronted property is located in the heart of Chorlton Green, on the popular Higson Avenue. This garden front home is situated in a prime location near the vibrant Beech Road, Providing a lively atmosphere and plenty of amenities at your doorstep with independent shops, bars and restaurants. Fantastic transport links into Manchester City Centre, Didsbury and further a field are close by. In brief the property consists of; a lounge to the front aspect benefitting from a bay window, a spacious living room, useful under stairs storage, a fitted kitchen, a W.C, and a conservatory which has access out into the rear paved garden. To the first floor there are two good sized double bedrooms, and a white three-piece bathroom suite. The property benefits from gas fired central heating, high ceilings, an alarm system, and a rear enclosed garden.





EPC Chart

Energy Efficiency Rating		
	Current	Potential
Very energy efficient - lower running costs		
(92 plus) A		
(81-91) B		
(69-80) C		
(55-68) D		
(39-54) E		
(21-38) F		
(1-20) G		
Not energy efficient - higher running costs		
England & Wales	EU Directive 2002/91/EC 	



Tenure: **Freehold** Council Tax Band: **B**

Ground Floor



First Floor

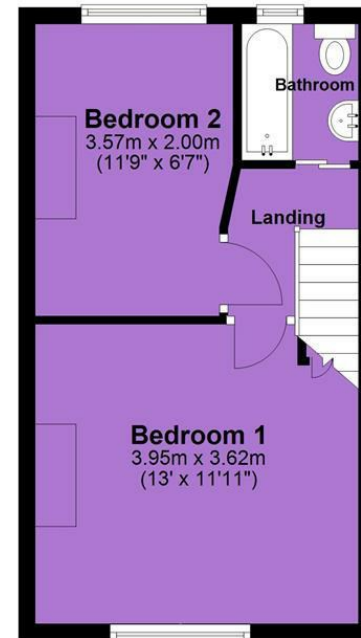

JP & Brimelow Estate Agents Ltd
430 Barlow Moor Road, Manchester, M21 8AD
Tel: 0161 8822233
E: sales@jpbrimelow.co.uk www.jpandbrimelow.co.uk



JP & Brimelow
ESTATE AGENTS

NOTICE: JP & Brimelow Estate Agents Ltd for themselves and for the vendors or lessors of this property whose agents they are give notice that:

- (i) the particulars are set out as a general outline only for the guidance of intending purchasers or lessees, and do not constitute, nor constitute part of, an offer or contract;
- (ii) all descriptions, dimensions, references to the condition and necessary permissions for use and occupation, and other details are given in good faith and are believed to be correct but any intending purchasers or tenants should not rely on them as statements or representations of fact but must satisfy themselves by inspection or otherwise as to the correctness of each of them;
- (iii) no person in the employment of JP & Brimelow Estate Agents Ltd has any authority to make or give any representation or warranty whatever in relation to this property.

jpandbrimelowestateagents

@jpandbrimelow